

# Holy Trinity C of E Primary Academy & Nursery



Principal: Mr R Dickson  
Middleton Road, Oswestry, Shropshire SY11 2LF,  
Tel: 01691 654832 Fax: 01691 688913  
Email: [admin@holytrinitycepa.co.uk](mailto:admin@holytrinitycepa.co.uk) [www.holytrinitycepa.co.uk](http://www.holytrinitycepa.co.uk)



4<sup>th</sup> March 2021

Dear Parents/Carers,

I am really excited about welcoming all of our children back to school, in fact I cannot wait.

## Attendance

From 8 March, school attendance will be mandatory and our usual rules on attendance will apply.

As a reminder, your child should self-isolate and not come to school if they:

- Have coronavirus symptoms or have tested positive
- Live with someone who has symptoms or who has tested positive
- Are a close contact of someone who has tested positive

In line with the latest government guidance, pupils who are **clinically extremely vulnerable** **should not attend school**. If your child is in this group, they should continue to learn from home until further notice. If your child does have a shielding letter please send a copy to school as soon as possible.

For pupils who are self-isolating or shielding, we will:

- Continue to offer remote learning and paper work packs. Your child's class teacher will contact individual families to discuss their expectations during this period.

## Our safety measures

Rest assured that we're doing everything we can to make sure our pupils can return to school safely. We'll be taking the following protective measures to keep everyone safe:

- New Procedures for going to and from school:
  - Staggered drop off and pick up times to keep groups apart as they arrive and leave – please see the separate instruction sheet and site map included with this letter.
  - 3 main entry and exit points – please familiarise yourself with your child's entrance and times.
  - Facemasks must be worn when on school premises.
  - When queueing to enter the school site please make sure that your children stay with you in the queue and do not run around and play with other children. Gates will not be open until stated times so please do not come early, this will avoid long queues.
  - If you are collecting children from the hall doors on Beech Grove car park there will be class areas signposted for Bubble 3 and Bubble 4 please wait in your child's class designated area.

*We are a Christian school where we value one another, want the best for everyone,  
work hard and enjoy the journey.*



*Deo Fretus – Trust In God*



# Holy Trinity C of E Primary Academy & Nursery



Principal: Mr R Dickson

Middleton Road, Oswestry, Shropshire SY11 2LF,

Tel: 01691 654832 Fax: 01691 688913

Email: [admin@holytrinitycepa.co.uk](mailto:admin@holytrinitycepa.co.uk)

[www.holytrinitycepa.co.uk](http://www.holytrinitycepa.co.uk)



- Please be reminded that gathering at the school gate is not allowed. Please leave the premises and the immediate areas outside and around the school as soon as possible.
- Rules on what pupils can bring to and from school:
  - Children need a water bottle with their name clearly labelled.
  - Lunch Bags
  - PE Kit – Children must come to school in their PE kit on relevant PE days
  - Ensure that all uniform and PE kit is labelled
- How we'll keep pupils safe in school:
  - Children will remain in their pre-existing family groups (Bubbles)
  - We will have a staggered lunchtime so children will not eat with other Bubbles
  - The playground will be sectioned into Bubbles
  - There will be minimum movement in the corridors and we will use outdoor spaces when appropriate.
  - All children will be instructed to sanitise their hands throughout the day.
  - Good hand hygiene will be promoted when visiting the toilet and this will be overseen by staff.
  - Children will be reminded of Catch It, Bin It, Kill it when using tissues in class.
- All children should attend school in full uniform, clearly labelled with their name and washed regularly to reduce the risk of any transmission of the virus.

There will be an updated copy of the whole school risk assessment on the school website on Monday 8<sup>th</sup> March. This will be after we have scrutinised our return to school plan on Monday morning and ironed out any problems.

Lockdown has been a challenging period for all of us, and we'd like to thank you for your continuing support during this difficult and uncertain time. If you or your child have any concerns about returning to school, or if you think your child might need extra support when they return, please get in touch with your child's class teacher via Class Dojo, Class email or ring the school office.

We'd also like to thank you for all your support in helping your child learn from home. We'll continue to keep in touch if we update our plans or if we need to make changes due to new government guidance.

Best Wishes

Mr R Dickson  
Principal

*We are a Christian school where we value one another, want the best for everyone,  
work hard and enjoy the journey.*



Deo Fretus – Trust In God





<b>Bubble 1</b> Nursery – Mrs Kenning Clee – Mrs Meddins Earlshill - Mrs Allcock	<b>Bubble 2</b> Wrekin – Mr Hughes Lawley – Mrs Thompstone Caradoc - Miss Wright	<b>Bubble 3</b> Longmynd – Miss Hutson Hawkstone – Miss Kerr	<b>Bubble 4</b> Stiperstones – Mrs Platt Haughmond – Miss Scoltock
---	---	--	--

To avoid congestion on the main path to Nursery and the back of school we have devised a new drop of and collection system. Please make yourself familiarise yourself with the new routes around school.

#### **MORNING DROP OFFS –**

**BUBBLE 1** – If your child is in Nursery, Clee or Earlshill class they will enter the school via the Nursery gate which will open at **8.40am** and no sooner. You will then follow the one-way path across the playground through the KS2 building and exit onto the path to Beech Grove.

**BUBBLE 2** – If your child is in Wrekin, Lawley or Caradoc class they will enter the school via the main KS1 entrance by main reception, please queue up the path adjacent to the main car park. These doors will open at **8.45am**. You will then continue to follow the path past the main office and exit onto Beech Grove.

**BUBBLE 3 & 4** – If your child is in Longmynd, Hawkstone, Stiperstones or Haughmond class they will enter school via the Hall doors on Beech Grove car park at **8.30am**. There will be a one way system in place where you will queue up on the left hand side of the car park (IN Gate) and follow the path along the car park and use the EXIT gate to leave.

#### **AFTERNOON COLLECTIONS –**

**BUBBLE 1** – If your child is in **Nursery** they will be collected at **3.00pm** using the same route as the morning drop off. Please be on time for collection to avoid congestion with Reception children.

**Clee or Earlshill** class they will be collected at **3.10pm** using the same route as the morning drop off. Please do not come any earlier to avoid congestion with Nursery pick ups.

**BUBBLE 2** – If your child is in **Wrekin, Lawley or Caradoc** class they will be collected from the main KS1 door at **3.10pm** please queue up the path adjacent to the main car park. You will then continue to follow the path past the main office and exit onto Beech Grove.

**BUBBLE 3 & 4** – If your child is in **Longmynd, Hawkstone, Stiperstones or Haughmond** class they will be collected from the Hall doors on Beech Grove car park at **3.15pm**. There will be a one way system in place where you will queue up on the left hand side of the car park (IN Gate) and follow the path along the car park and use the EXIT gate to leave.

#### **IMPORTANT INFORMATION – If you have more than one child in school**

If you have children in **more than one** bubble in EY, KS1 and KS2 you can drop off/collect your children whilst walking across the playground to/from the classroom doors. You must arrive at **8.40am** and follow the **RED** pathway. The gate will not be open any earlier but your child will not be marked late if they are in Bubble 3.

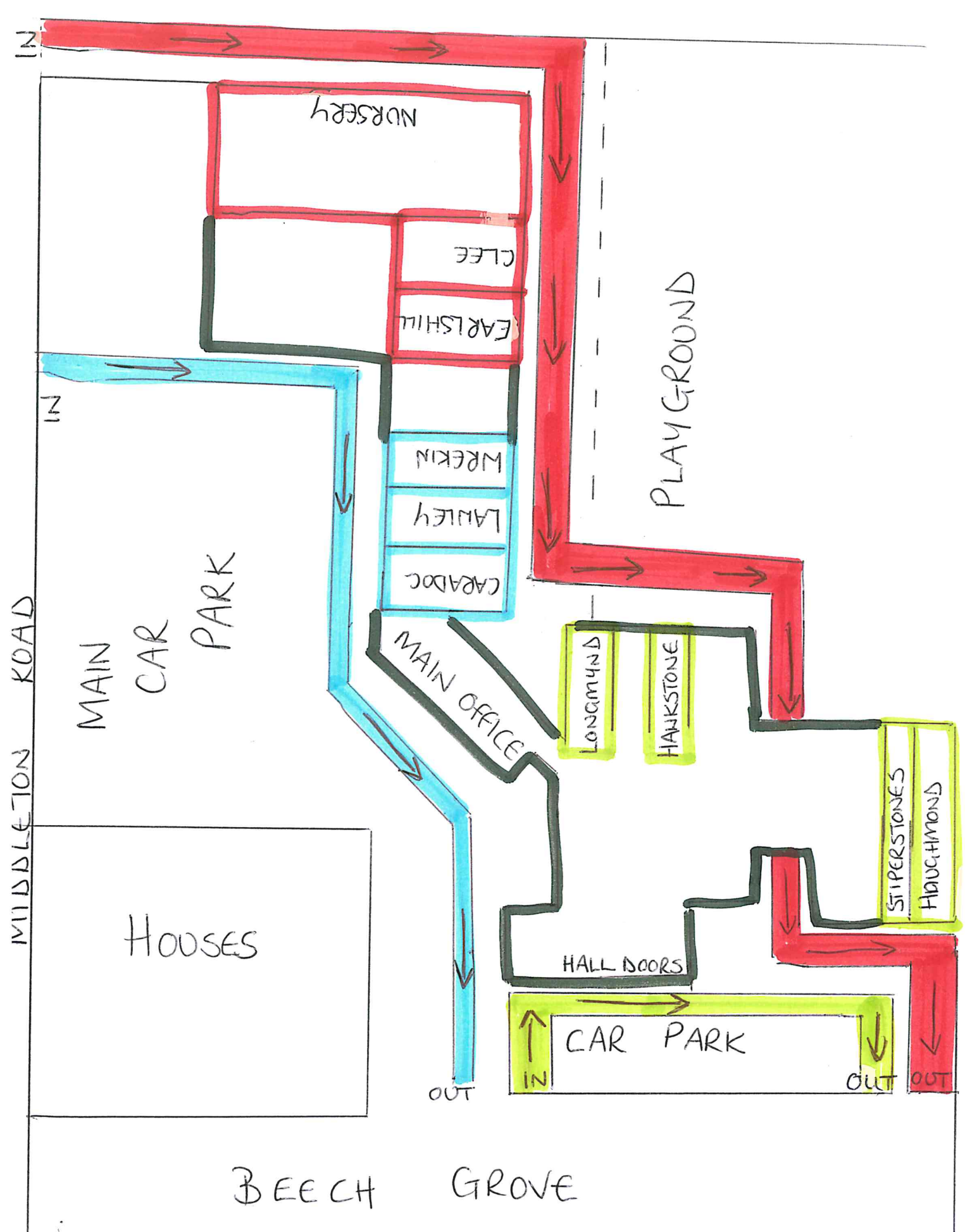

BUBBLE 1	8.40 \ 3.00
BUBBLE 2	8.45 \ 3.10
BUBBLE 3/4	8.30 \ 3.15